

RoHS
COMPLIANT

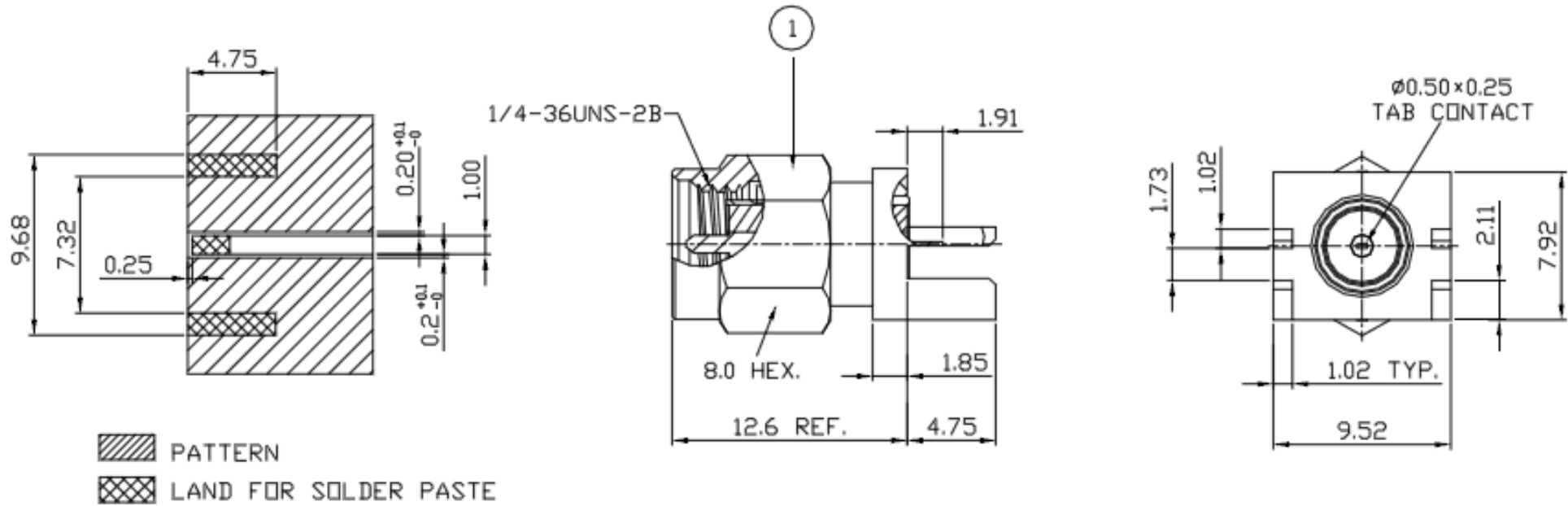

Scale: 2:1

2	TRAY	1/50	NONE	NONE
1	INSULATOR	1	TEFLON	NONE
	RING	1	BRASS	GOLD PLATED
	BODY	1	BRASS	GOLD PLATED
	C-RING	1	SUS-304	CLEANED
	O-RING	1	SILICON RUBBER	NONE
	CONTACT	1	BRASS	GOLD PLATED
	SHELL	1	BRASS	GOLD PLATED
NO.	DESCRIPTION	QTY	MATERIAL	FINISH

RoHS
COMPLIANT

- NOTES: FINISH (PLATING THICKNESS IN MICRO-INCHES)
1. BRASS PER QQ-B-626
 2. NICKEL PL 70 MIN THICK OVER COPPER STRIKE
 3. GOLD PL 3 MIN OVER NICKEL PL 70 MIN THICK OVER COPPER STRIKE
 4. TEFLON MIL-P-19468
 5. BRASS JIS H 3250, C 2700

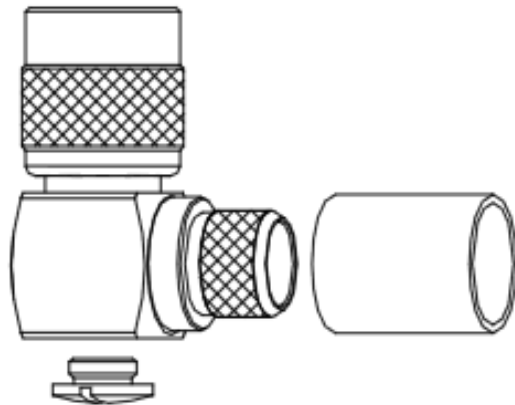
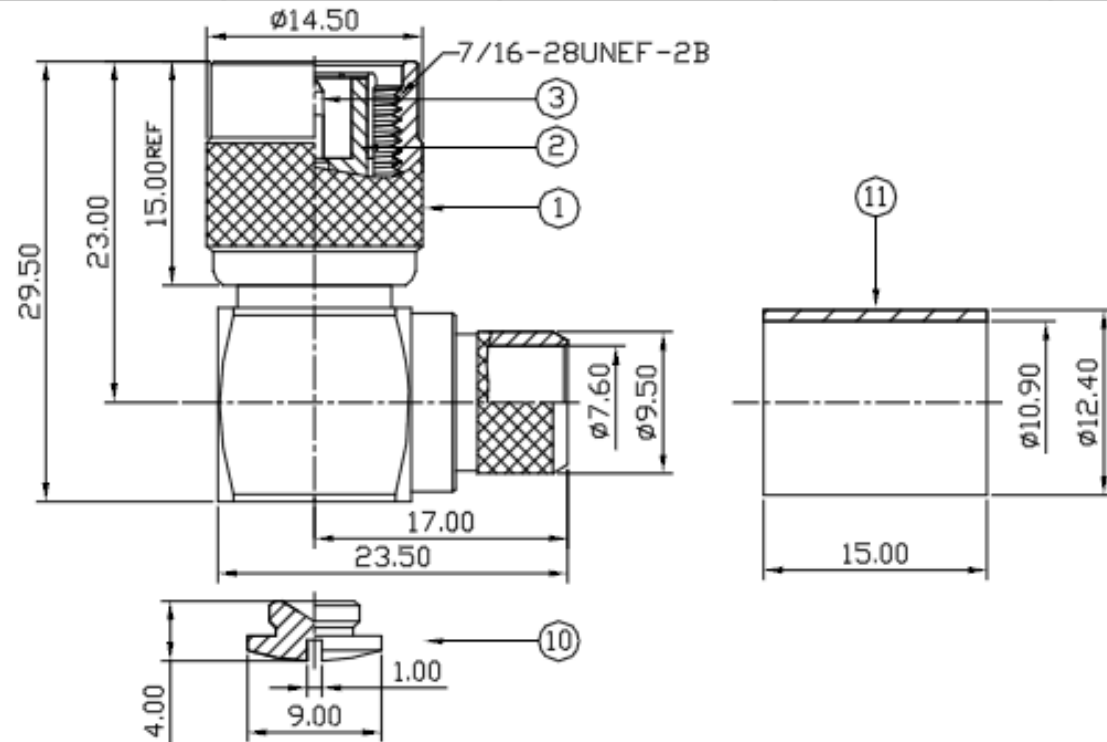

Scale: 1.5:1

11	FERRULE		NOTE 5	NOTE 2
10	COVER		NOTE 1	NOTE 2
9	SHELL		NOTE 1	NOTE 2
8	O-RING		SILICONE	RED
7	C RING		SS41	NOTE 2
6	WASHER		DELRIN	NATURAL
5	WASHER		SS41	NOTE 2
4	CUBE BODY		NOTE 1	NOTE 2
3	CONTACT PIN		NOTE 1	NOTE 3
2	INSULATOR		NOTE 4	WHITE
1	BODY		NOTE 1	NOTE 2
NO.	DESCRIPTION	QTY	MATERIAL	FINISH