

常州市创联电源科技股份有限公司

Changzhou Chuanglian Power Supply Technology Corporation

承认书

CERTIFICATE FOR CONFIRMATION

客户名称 (CUSTOMER) : _____
客户料号 (PART NO.) : _____
产品名称 (PART NAME) : Switching Power Supply
产品规格 (DESCRIPTION) : A-35FAL
编制日期 (DATE) : _____

| | | |
|------------------|--------------------|--------------------------|
| 制定 (Engineer) | 审核 (Supervisor) | 核准 (Engineer Manager) |
| 承认 (Engineer) | 审核 (Supervisor) | 核准 (Engineer Manager) |

注:此承认书一式二份,请签核完后寄回我司一份保存。

Remark:This certification is in duplicate,please send us a copy signing.

厂商:常州市创联电源科技股份有限公司
地址:江苏省常州市钟楼经济开发区童子河西路8号

电话:86-519-85215050, 85210525

传真:86-519-85215252, 85215770

网址:www.haitaik.com

邮箱:ad@haitaik.com

Mfr.:Changzhou Chuanglian Power Supply Tech Corp

Address:No. 8, Tongzihe West Road, Zhonglou Economic Development Zone, Changzhou, Jiangsu 213024, China

Tel:86-519-85215050, 85210525

Fax:86-519-85215252, 85215770

Web:www.haitaik.com

E-mail:ad@haitaik.com

编号:



A-35FAL Switching Power Supply



◆ Features:

- Universal AC input
- No load power consumption < 0.2W
- Protections: short circuit/overload
- Cooling by free air convection
- 100% pass aging test
- 3 years warranty

General Specifications

| Model No. | A-35FAL-5 | A-35FAL-12 | A-35FAL-24 | A-35FAL-36 | A-35FAL-48 | |
|--------------------|---|--|------------|------------|------------|----------|
| Output | DC voltage | 5V | 12V | 24V | 36V | 48V |
| | Rated current | 7A | 3A | 1.5A | 1A | 0.8A |
| | Current Range | 0~7A | 0~3A | 0~1.5A | 0~1A | 0~0.8A |
| | Rated power | 35W | 36W | 36W | 36W | 36W |
| | Ripple & Noise | 80mVp-p | 120mVp-p | 150mVp-p | 200mVp-p | 200mVp-p |
| | Voltage regulation range | ±10.0% | | | | |
| | Voltage accuracy | ±1.0% | | | | |
| | Line adjustment rate | ±0.5% | | | | |
| | Load adjustment rate | ±0.5% | | | | |
| | Rise | 1000ms, 30ms/230VAC 100% load | | | | |
| Hold up time (Typ) | 30ms/230VAC 12ms/115VAC 100% Load | | | | | |
| Input | Voltage range | 100~240VAC; | | | | |
| | Frequency | 47~63HZ | | | | |
| | PFC (Typ) | | | | | |
| | Efficiency (Typ) | 82% | 86% | 88% | 88% | 89% |
| | Alternating current | 0.7A/115VAC 0.42A/230VAC | | | | |
| | Inrush current (Typ) | 45A/230VAC | | | | |
| Leakage current | <3.5mA/240VAC | | | | | |
| | | | | | | |
| Protecti ons | Overload | 110~150% of rated output | | | | |
| | Short circuit | Hiccup mode, auto-recovery | | | | |
| Envirome nt | Working temp. | -30℃~+50℃ (refer to output derating curve) | | | | |
| | Working humidity | 20~95%RH non condensing | | | | |
| | Storage temp. | -40℃~+85℃ | | | | |
| | Storage humidity | 10~95%RH non condensing | | | | |
| | temp. coefficient | ±0.03%/℃ (0~50℃) | | | | |
| | Vibration resistance | 10~500Hz, 2G, 10min/cycle, X、Y、Z 60min in each direction | | | | |
| Safety | Safety standards | design accoring to GB4943-2001, UL1012 | | | | |
| | withstand voltage | I/P-O/P:3.0KV AC、I/P-FG: 2.0KV AC、O/P-FG: 0.5KV AC | | | | |
| | Isolation Resistance | I/P-O/P、I/P-FG、O/P-FG: 100MΩ/500VDC | | | | |
| | EMC | EN55022 CLASS B | | | | |
| Others | Lifetime | 100,000 hours (25℃) | | | | |
| | Size | 99×82×30 (L*W*H) | | | | |
| | Weight | 0.23Kg/pc | | | | |
| Rmarks | <p>*In order to extend the lifetime, it is recommended to configure the load no more than 30% of the remaining allowance. For example: the power of the device requires 100W, then use the power of less than 130W.</p> <p>*Ripple test method: 20MHz oscilloscope in power output terminal test, oscilloscope probe wire length is not more than 12mm, and input parallel 47uF electrolytic capacitors and 0.1uF high frequency capacitance probe.</p> | | | | | |



Load temperature drop curve

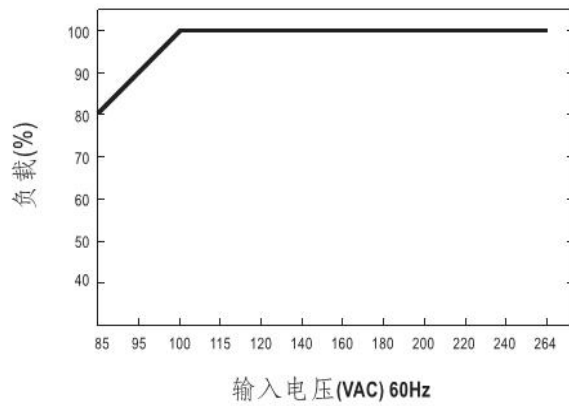
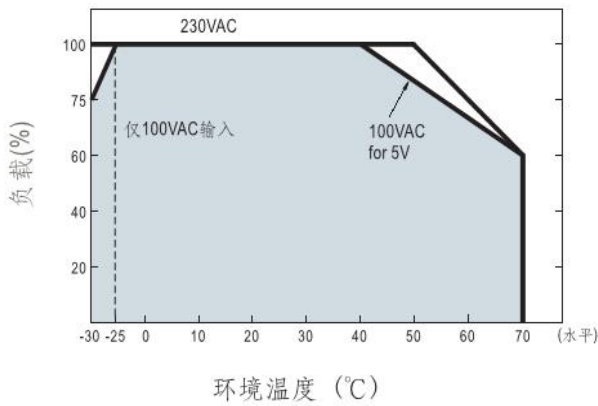

Installation

警示

Warning

- 使用安装螺丝M3*6mm,
Using the mounting screws M3*6mm
- 深入外壳螺丝深度MAX 4mm,
Deep housing screw depth Max 4mm
- 详见右图
As shown on the right

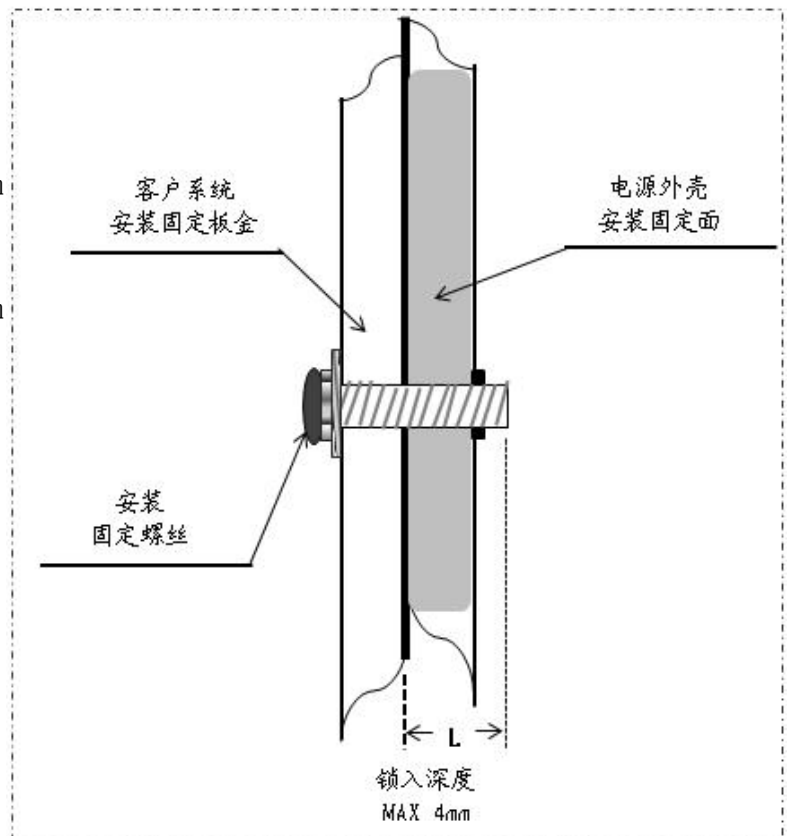



A-35FAL Switching Power Supply

Drawing:

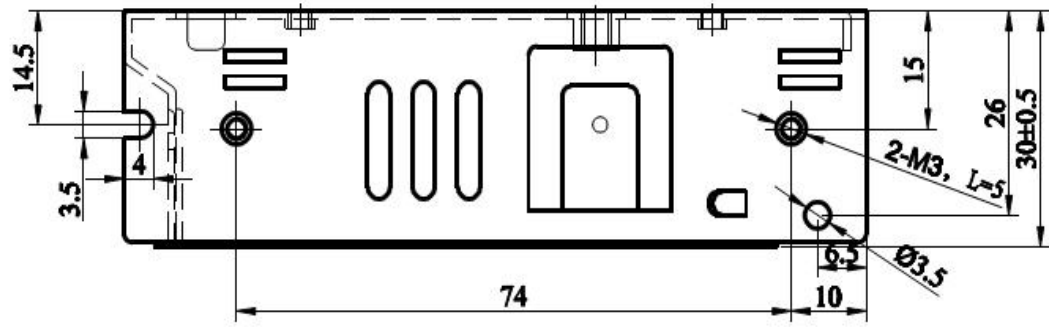
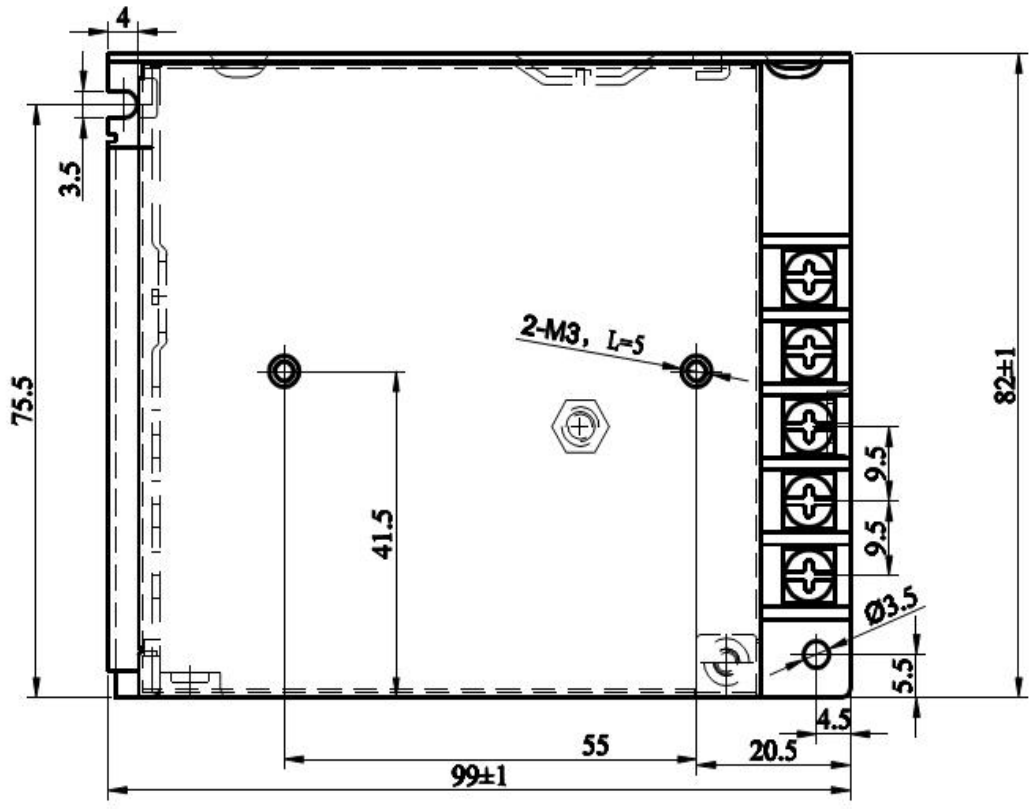

| Pin No. | Assignment | Pin No. | Assignment |
|---------|------------|---------|----------------|
| 1 | AC/L | 4 | DC output (V-) |
| 2 | AC/N | 5 | DC output (V+) |
| 3 | FG | | |