

REVISION RECORD				
REV	ECN	DESCRIPTION	DRFT	DATE

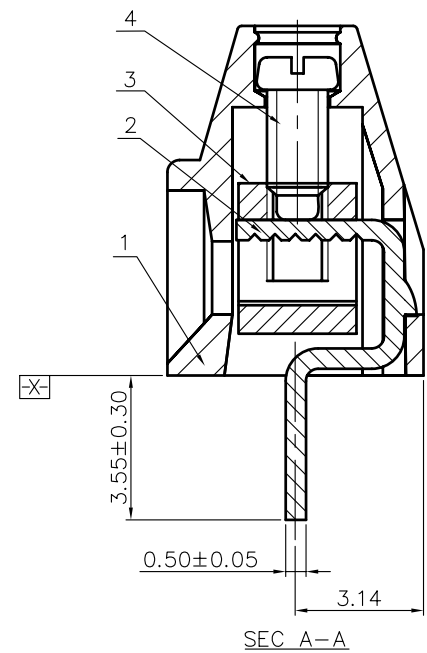

- NOTES:
- 1.DIMENSION SHALL BE INTERPRETED PER ASME Y14.5-2009.
  - 2.PITCH: 2.54MM,POLES: 2-12P
  - 3.RATED VOLTAGE/CURRENT: UL 150V/6A  
VDE 130V/8A
  - 4.OPERATION TEMPERATURES: -40 °C~+105 °C
  - 5.WITHSTANDING VOLTAGE: AC2000V/1MIN.
  - 6.INSULATION RESISTANCE: 5000M Ω/DC1000V
  - 7.WIRE RANGE: 26~18AWG,1.0MM<sup>2</sup>
  - 8.TORQUE VALUE: M1.6,1.5KGF.CM
  - 9.UNDIMENSIONED TOLERANCES:

PITCH RANGE IN MM		NOMINAL DIMENSION RANGE IN MM						-
	OVER 10 TO 6	OVER 10 TO 24	OVER 30 TO 30	OVER 30 TO 60	OVER 60 TO 100	OVER 100 TO 150	OVER 150	
±0.10	±0.15	±0.25	±0.20	±0.30	±0.50	±0.70	±1.00	0.05/10

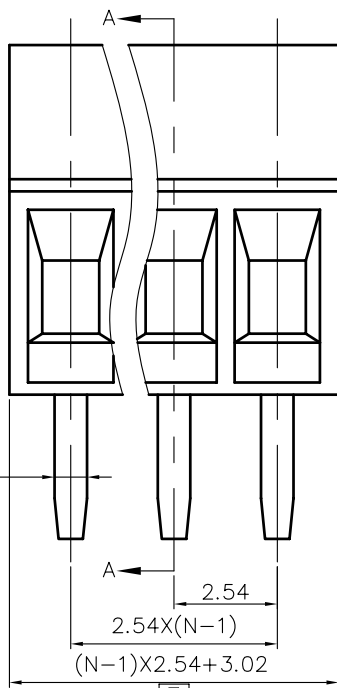
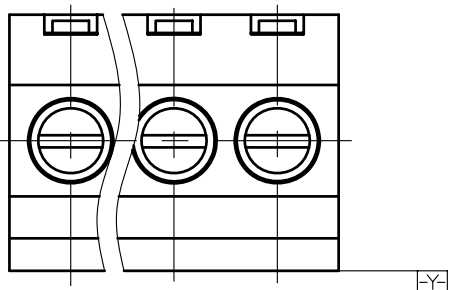
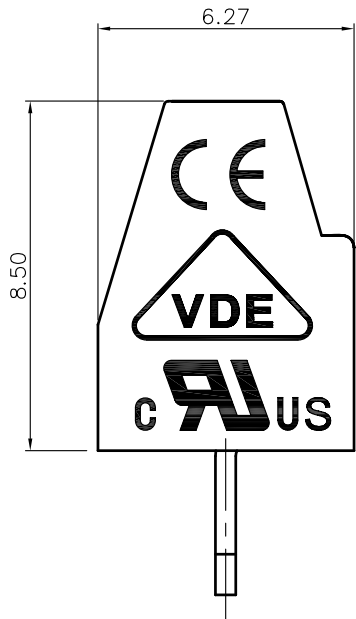
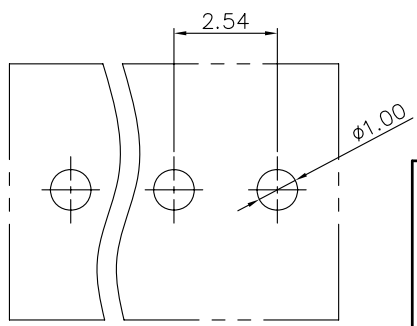

ITEM	NAME OF PART	NO. OF PART	Q'TY	MATERIAL	NOTES
4	DG308-Screws	S000000500(H)	XX	Steel	Cr <sup>3+</sup> Zn
3	DG308-1000A Cage	X000005100(H)	XX	Brass	Ni plated
2	DG308-Pin header	4024B00010(H)	XX	Phosphor Bronze	Sn plated
1	DG308-Housing	4024A0YXXA(H)	1	PA66	UL94V-0

DETACHED LISTS	TOLERANCES EXCEPT AS NOTED .X ±     .X' ± .XX ±    .XX' ± .XXX ±   .XXX' ±		MATERIAL: FINISH: PART NO.:		<b>DEGSON®</b> NAME: DG308-2.54-XXP-1Y-00A(H)	
	ANGLES ± 1°		APPD: CHKD: DRFT:TONGXC 03/03/04"			
	THIRD ANGLE PROJECTION		TITLE: ASSEMBLY DRAWING		REV	T8
			DO NOT SCALE DRAWING		SCALE	1:1
				SHEET	1/1	