



DEVETECH ELECTRONICS, CO. LTD.

Address: 11/F., F. Block, Hang Lok Building, 130 Wing Lok St., Hong Kong.
 Address: A3L1, Youpinyishu, Huanmei Rd., Dameisha, Yantian district, Shenzhen, China
 Tel: (86) 13632770721
 Email: sales@devetechelectronics.com Website: www.devetechelectronics.com

DVT-CTWT

Precise fine tuning ceramic capacitors type DVT-CTWT

OUTLINE DRAWING

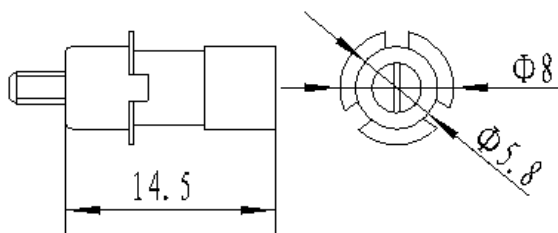

INTRODUCTION

Use metal shaft and metal copper as electrode, high precision ceramic material as medium, regulate capacitance through high precision metal shaft and with thermocouple function.

CHARACTERISTIC

- Stable performance.
- Good frequency characteristics, low dissipation factor.
- High insulation resistance.

USAGE

Widely used in instruments, control temperature of sensor, fine tuning circuit.

REFERENCE STANDARD

IEC 566

SPECIFICATIONS

Operating temp range	-40°C~+105°C	
Capacitance range	1PF~20PF (23°C f=1MHz)	
Rated voltage	250V~630V.DC	
Capacitance tolerance	±5%(J) ±10%(K)	
Dissipation factor	≤20X10 ⁻⁴ (23°C f=1MHz)	
Withstand voltage	1.75U _N (10S)	
Insulation resistance	CXR _i ≥50000MΩ	(23°C 1min)

Special requirements can be designed at the request of customers.