

SPECIFICATIONS

ELECTRICAL LIFE : 500,000 cycles min, for
 ELTS□W-69, 67, 65, 64
 100,000 cycles min. for
 ELTS□W-66, 68

CONTACT RESISTANCE: 100mΩ max
 INSULATION RESISTANCE: 100MΩ min. 500VDC
 DIELECTRIC STRENGTH: 250VAC/1 min
 OPERATION FORCE:
 360±90gf, Transparent(T), ELTS□W-65,67,69
 260±70gf, Red(R), ELTS□W-64, 65, 67, 69
 180±50gf, Brown(N), ELTS□W-64, 65, 67, 69
 160±50gf, Brown(N), ELTS□W-66
 160±50gf, Silver(S), ELTS□W-68
 STORAGE TEMPERATURE: -30°C to +80°C
 CONTACT ARRANGEMENT: 1 pole 1 throw

MATERIALS

COVER - Stainless steel.
 BASE - UL94V-0 Nylon High-Temp. Thermoplastic(Black)
 CONTACT DISC - Phosphor bronze with silver cladding
 TERMINAL - Brass with silver cladding

| ITEM NO. | ELTSMW-66N ELTSHW-66N | ELTSMW-68S ELTSHW-68S | ELTS(H)MW-69,67,65,64N (R) 69, 67T |
|---------------|--|--|---------------------------------------|
| STEM | High- Temp. Thermoplastic Nylon UL 94V-0 Color: Brown(N),160gf | None | None |
| ADHESIVE TAPE | Resin-based | Resin-Based | None |
| METAL STEM | Brass with Nickel plated | Brass with Nickel Plated Color: Silver (S), 160gf | None |
| SEALED RUBBER | None | None | Silicone Rubber |

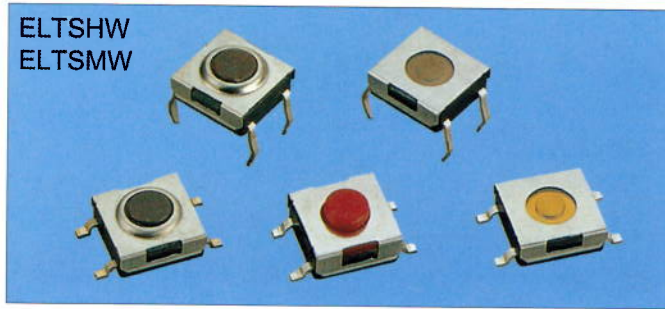
DIMENSIONS

ELTSHW-66

ELTSHW-68

ELTSHW-69,67,65,64

ELTSMW-66

ELTSMW-68

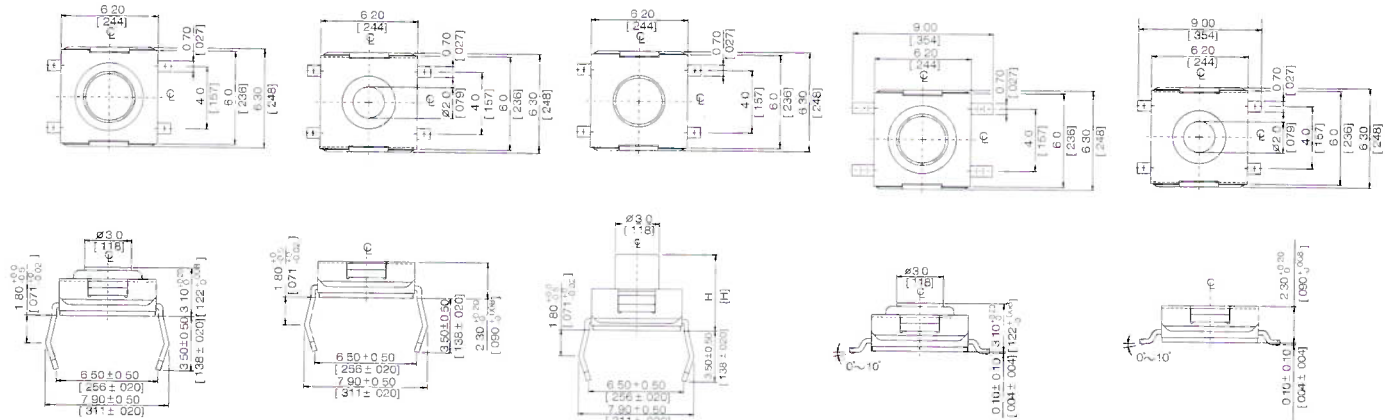

ELTSJW-66

ELTSJW-68

ELTSJW-69,67,65,64

ELTSMW-69,67,65,64

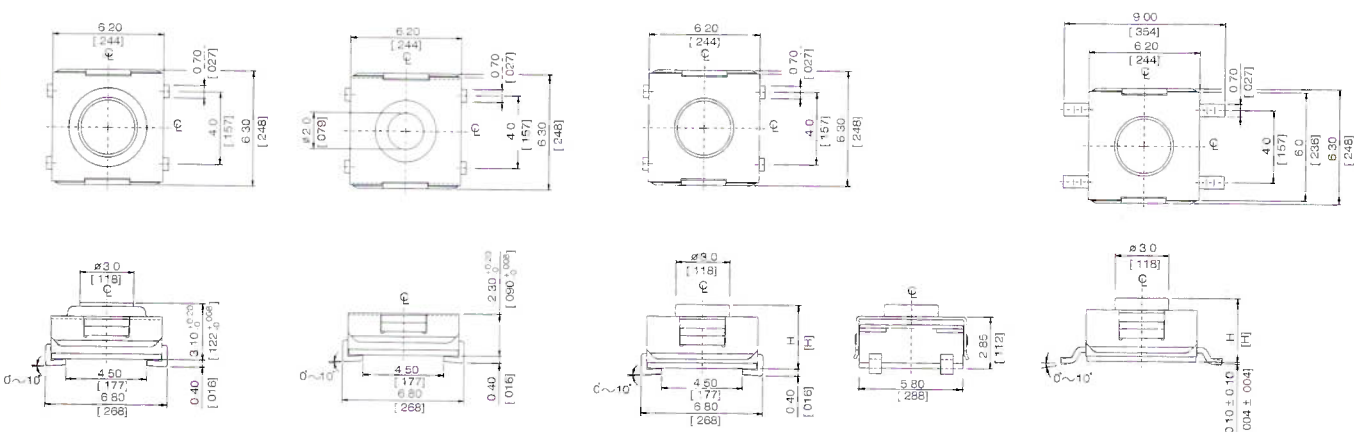

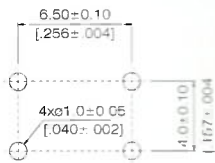
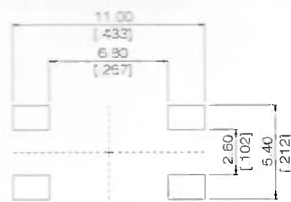
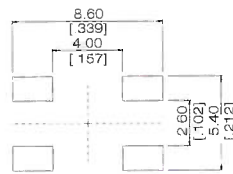
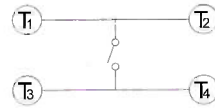
P.C.B. LAYOUT
ELTSHW-6

ELTSMW-6

ELTSJW-6

CIRCUIT

HOW TO ORDER
ELTS W - - - - -
Package Style:

□ = Bulk

B = Tube

T/R = Tape & Reel

RoHS code

H = RoHS Compliant

Color of Stem For Operating Force:

▲N= Brown, 160gf(66N), 180gf(69N, 67N, 65N, 64N)

S= Salmon, 160gf

R= Red, 260gf

T= Transparent, 360gf (69T, 67T, 65T)

Dimension H:

64= 4.5mm (N, R)

67= 5.2mm (N, R, T)

65= 3.5mm (N, R, T)

68= 2.3mm (S)

66= 3.1mm (N)

69= 3.8mm (N, R, T)

H= Through Hole Terminals

M= Surface Mounting Terminals

J = J Type Surface Mounting

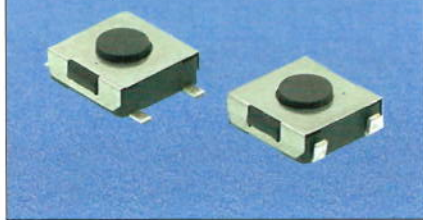
ELTS(G)L, F-6

SPECIFICATIONS
RATING: 50mA, 12VDC

ELECTRICAL LIFE: 1,000,000 cycles

CONTACT RESISTANCE: 100mΩ max

INSULATION RESISTANCE: 100MΩ min. 500VDC

DIELECTRIC STRENGTH: 250VAC/1 min

OPERATION FORCE: 100gf, 160gf, 260gf

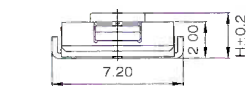
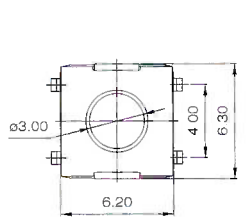
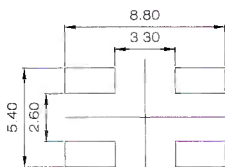
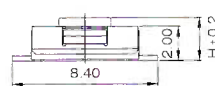
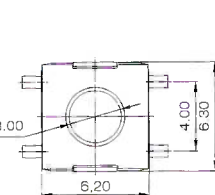
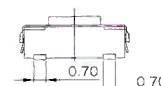
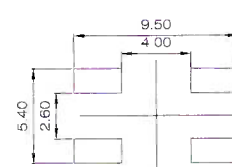
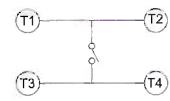
DIMENSIONS
ELTSL-6

P.C.B. LAYOUT

ELTSF-6

P.C.B. LAYOUT

CIRCUIT

HOW TO ORDER
ELTS □ □ - 6 □ □ - □ - □
Prod. Series

□ = Without ground terminal

G = With ground terminal

Terminal style

L = With L.S.M.T

F = With F.S.M.T

Total Height H

0 = 2.0mm

1 = 2.5mm

2 = 3.1mm

Color Of Stem For Operating Force

K = black, 100g

N = brown, 160g

R = red, 260g

H = RoHS Compliant

Package Style

□ = bulk

T/R= Tape & Reel

B = Tube