

C1 S 01 - T 2 1 - H 01

RoHS
Compliant

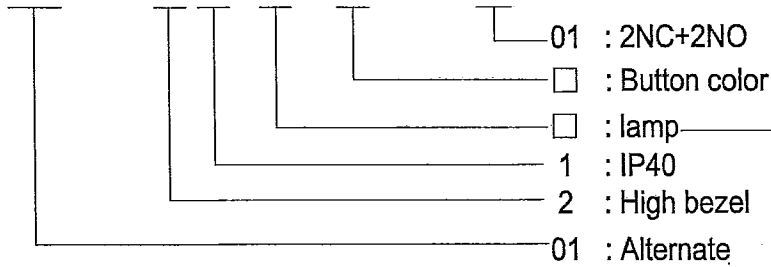

- B : Blue
 - G : Green
 - O : Orange
 - R : Red
 - W : White
 - Y : Yellow
-
- H : LED 6V DC
 - J : LED 12V DC
 - K : LED 24V DC

Soldering/Plug-in Type Pushbutton Switch

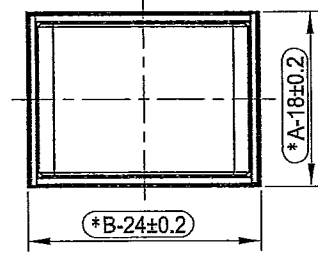
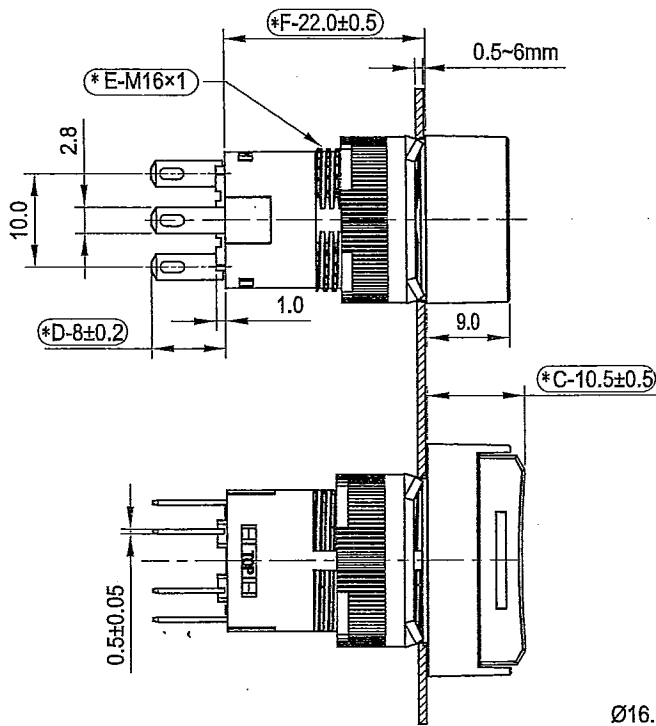

Hole Dia

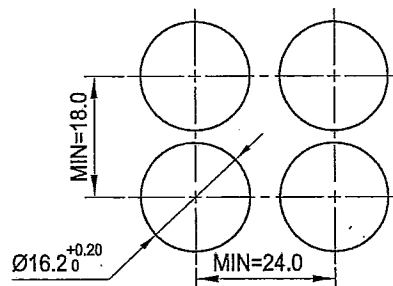

Product Specifications

- Mechanical life : >100,000 operations
- Electrical rating : 250V AC 3A
- Max. insulation voltage : 1500V 60Hz 1min
between all terminals
- Panel thickness : 0.5mm~6mm
- Degree of protection : IP40
- Storage temperature : -30°C to +80°C
- Operating temperature : 25°C to +55°C
- Contact resistance : <50mΩ(initial)
- Insulation resistance : 100MΩ

Bottom view

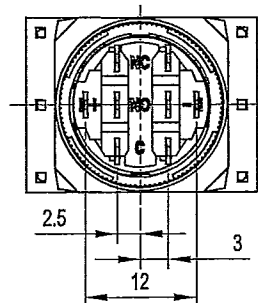

Electrical Diagram

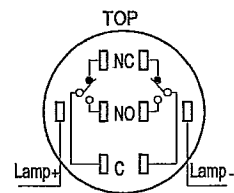

DECA[®] SwitchLab INC.

CONFIRMED &
ACCEPTED BY:

文件管制
APR 18 2012
文管中心

DRAWING NO.	C1S01-T21 <input type="checkbox"/> <input type="checkbox"/> -H01	VERSION	A	CONFIRMED BY	<i>[Signature]</i>
SHEET OF	2/2	METRIC	MM	DRAWN BY	<i>Leug</i>
		DATE	2012/4/18	GENERAL MANAGER	<i>[Signature]</i>